

REDI LARGE DIAMETER FITTINGS

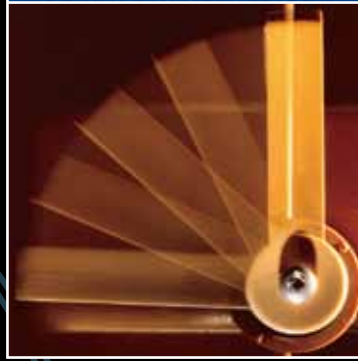

REDI LARGE DIAMETER FITTINGS

Made from uPVC, the range of REDI large diameter fittings are designed for non-pressure applications including stormwater, commercial rainwater and rural installations.

This European range of fittings are designed and manufactured by Redi, an Italian company specialising in drainage and non-pressure solutions.

The fittings have parallel-socket solvent joints and require the use of priming fluid prior to applying Marley Gold Solvent Cement.

The fittings are primarily designed for buried applications and require protection for use above ground where exposed to direct sunlight. Marley recommends these fittings should be protected by painting with a light coloured acrylic paint or be covered.



Stormwater

Suitable for large diameter stormwater installations. Use with large diameter stormwater pipes



Rural

For the farming / agriculture sector. Use with culvert pipe for gateway crossings or any drainage pipe system



Commercial

Fittings fit for use with large diameter downpipe options for commercial building installations.



Product Details

- Product range: bends, junctions, couplers, reducers and end caps
- Size range 175DN (200 OD), 225DN (250 OD), 300DN (315 OD)
- Stiffness SN \geq 4 kN/m²

Installation Requirements

- Parallel sockets – use Marley Joining Priming fluid (available in 500ml (CF500) or 4L (CF400) and Marley Gold Solvent Cement (available in 250ml (MG125), 500ml (MG500), 1250ml (MG1250), 4L (MG4000)).
- UV exposure – paint fittings with light coloured paint, or cover
- If installed according to the above installation requirements, these fittings comply to AS/NZS1254 standards

REDI STORMWATER LARGE DIAMETER FITTINGS

Plain Bend 45° (F & F)

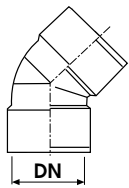

CODE	PIPE SIZE	DN (ID)	ANGLE
701M.175.45	175	200	45°
701M.225.45	225	250	45°
701M.300.45	300	315	45°

Plain Bend 90° (F & F)

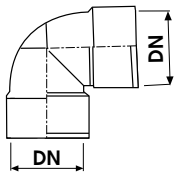

CODE	PIPE SIZE	DN (ID)	ANGLE
701M.175.90	175	200	88°
701M.225.90	225	250	88°
701M.300.90	300	315	88°

Plain Junction 45° (F & F)

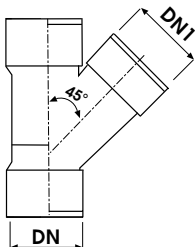

CODE	PIPE SIZE	DN (ID)	DN1 (ID)	ANGLE
704M.175.45	175 x 175	200	200	45°
704M.225.45	225 x 225	250	250	45°
704M.300.45	300 x 300	315	315	45°

All dimensions in millimeters

REDI STORMWATER LARGE DIAMETER FITTINGS

Plain Junction 90° (F & F)

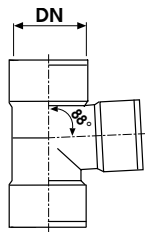

CODE	PIPE SIZE	DN (ID)	DN1 (ID)	ANGLE
704M.175.90	175 x 175	200	200	88°
704M.225.90	225 x 225	250	250	88°
704M.300.90	300 x 300	315	315	88°

Reducing Junction 45° (M & F)

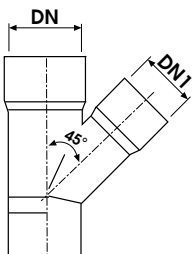

CODE	PIPE SIZE	DN (ID)	DN1 (ID)	ANGLE
704M.175.100.45MF	175 x 100	200	110	45°
704M.175.150.45MF	175 x 150	200	160	45°
704M.225.150.45MF	225 x 150	250	160	45°
704M.225.175.45MF	225 x 175	250	200	45°

Reducing Junction 90° (F & F, M & F)

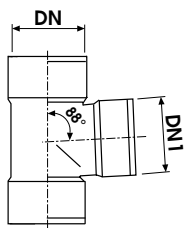

CODE	PIPE SIZE	DN (ID)	DN1 (ID)	ANGLE
704M.175.150.90FF*	175 x 150	200	160	88°
704M.175.150.90MF	175 x 150	200	160	88°

REDI STORMWATER LARGE DIAMETER FITTINGS

Slip Coupler

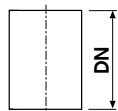

CODE	PIPE SIZE	DN (ID)
710M.175	175	200
710M.225	225	250
710M.300	300	315

Level Invert Reducer

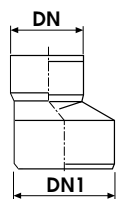

CODE	PIPE SIZE	DN (ID)	DN1 (ID)
723M.150.100	150 x 100	160	110
723.175.100*	175 x 100*	200	110
723M.175.150	175 x 150	200	160
723M.225.100	225 x 100	250	110
723M.225.150	225 x 150	250	160
723M.225.175	225 x 175	250	200
723M.300.150	300 x 150	315	160
723M.300.175	300 x 175	315	200
723M.300.225	300 x 225	315	250

Female End Cap

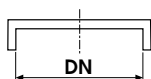

CODE	PIPE SIZE	DN (ID)
737M.175	175	200
737M.225	225	250
737M.300	300	315

All dimensions in millimeters
* Fabricated fitting

NON-RETURN VALVE

Check Valve: Simple, easy and effective

The newly restyled REDI valve is a simple and effective way to eliminate flood risk by backflow through drainage channels. New Zealand Building Code Regulations G.13 require provision be made to protect a building where surcharge may occur.

Particularly suitable for:

- Low – lying coastal, lake or valley areas, especially where rain water is channelled downstream to the main sewer, making it liable to flash-floods after heavy rainfalls.
- Under-dimensioned sewage networks with recent or scheduled new dwellings being connected on a previous main sewer operating at a high flowrate.
- Private discharge systems channelled to public sewers equipped with pumping stations.
- Commercial and industrial installations where non-pressure flow control is required (i.e. fish farming) or where uPVC's corrosion resistance performance is required (salt water).
- Rodent ingress reduction.

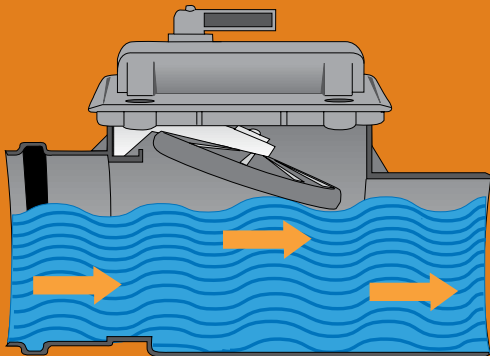

NORMAL WORKING SITUATION

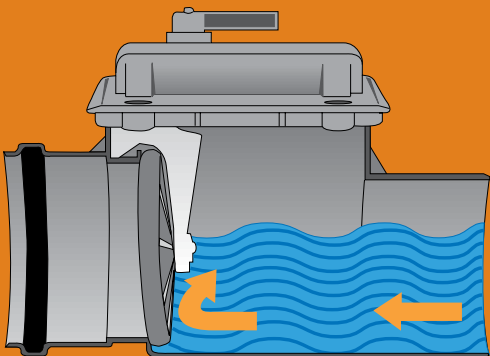

EFFECTIVE ANTI-FLOODING

Slide-in Flap Support

Made from technopolymer. Ideal for impact absorption and bending resistance. All parts are removable for periodic servicing.



Internal Shape

Built-in waterfall. No reduced crossed flow section.

100, 150 & 175 Diameter

DN	S	L1	L2
100	4.0	61	61
150	4.0	74	74
175	4.5	100	86



L4

Closing Handle

Locking device allows valve to be locked in open or closed positions

Top Inspection Cover

Fixed with stainless steel nuts. Leak-tightness created by a flat seal. Tested at 5 metres head.

Main Body

Rigid uPVC injection moulded with structural ribs. Socket fitted with elastomeric lip-ring. Spigot outlet.

Inspection Chamber

Internal profile specially designed to provide uninterrupted flow (no reduced crossed flow section). Full access for pipe cleaning or rodding.

Flap Gasket

Twin-lip profile to ensure optimal water tightness.

Plastic Flap

Rigid uPVC injection moulded. Completely removable for servicing.

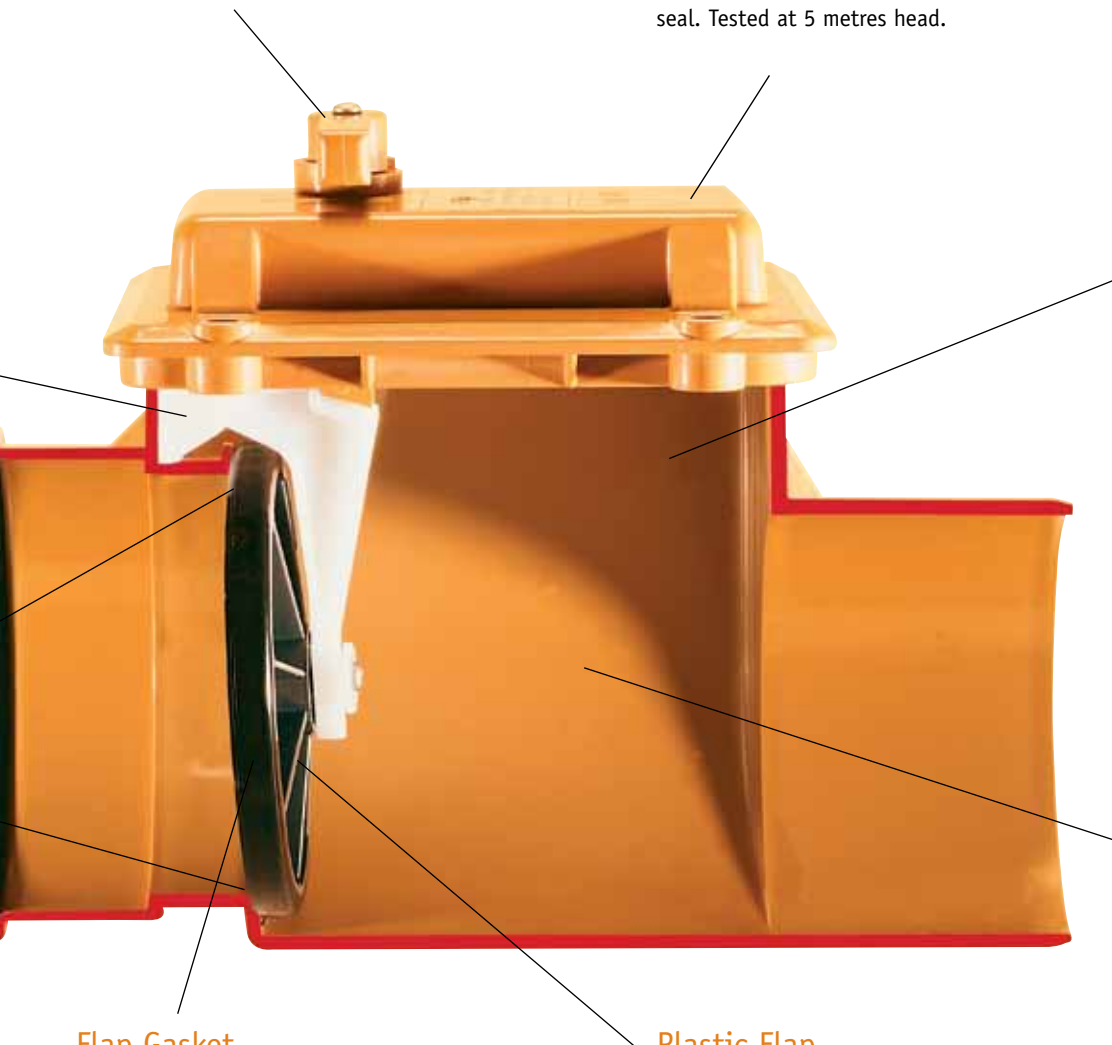

Non-return Valve		
L3	L4	CODE
307	230	1588.100
337	255	1588.150
451	300	1588.175

225 & 300 Diameter Non-return Valve						
DN	S	L1	L2	L3	L4	CODE
225	6.2	130	102	520	374	1588.225
300	7.7	160	125	615	440	1588.300

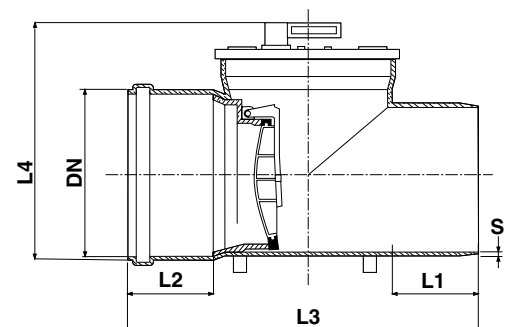
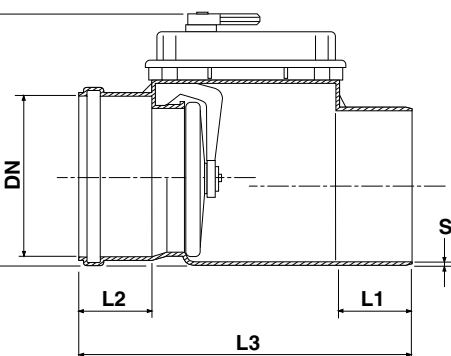

For installation instructions refer to www.marley.co.nz



DISCLAIMER

This technical catalogue has been compiled by Marley New Zealand Limited ("The Company") to promote better understanding of the technical aspects of the Company's products to assist users in obtaining from them the best possible performance.

The technical catalogue is supplied subject to acknowledgment of the following conditions:

The technical catalogue is protected by Copyright and may not be copied or reproduced in any form or by any means in whole or in part without prior consent in writing by the Company.

Product specifications, usage data and advisory information may change from time to time with advances in research and field experience.

The Company reserves the right to make such changes at any time without notice.

Correct usage of the Company's products involve engineering judgements which cannot be properly made without full knowledge of all the conditions pertaining to each specific installation. The Company expressly disclaims all and any liability to any person whether supplied with this publication or not in respect of anything and of the consequences of anything done or omitted to be done by any such person in reliance whether whole or partial upon the whole or any part of the contents of this publication.

No offer to trade, nor any conditions of trading, are expressed or implied by the issue or content of this manual.

Nothing herein shall override the Company's Conditions of Sale, which may be obtained from the Registered Office or any Sales Office of the Company.

This technical catalogue is and shall remain the property of the Company, and shall be surrendered on demand to the Company.

AUCKLAND - Mahia Road, Manurewa,
Private Bag 802, Manurewa.

Sales Department Tel: 09 279 2777

Direct Fax: 09 279 2778

Freefax: 0800 652 621

Head Office Tel: 09 279 2799

Fax: 09 279 2798

CONTACT CENTRE: 0800 222 922

CHRISTCHURCH

Shands Road, Hornby,
PO Box 16233 Christchurch.

CONTACT CENTRE: 0800 222 922

For more information: **0800 MARLEY (0800 627 539)**

www.marley.co.nz

an **Aliaxis** company

Plumbing & Drainage Solutions

 **MARLEY**[®]